

1967

**SHELBY GT500**

# SUPER SNAKE

**1:8 SCALE**



## Pack 05 | Build Instructions

Your Shelby GT500 Super Snake is a finely detailed model replicating every aspect of the original car. From the paint color to the smallest interior details, every piece is precisely reproduced. .

In your fifth model pack, you will assemble:

**STAGE 31: STABILIZER BAR AND  
LOWER SUSPENSION ARMS**

**STAGE 32: UPPER SUSPENSION ARMS**

**STAGE 33: FRONT INTERIOR  
FLOOR AND GEAR LEVER**

**STAGE 34: FRONT SIDE WALLS,  
PEDALS AND SWITCHES**

**STAGE 35: DASHBOARD AND FUSE COVER**

**STAGE 36: DASHBOARD TRIM,  
DIALS AND SHELBY BADGE**

**STAGE 37: CENTRAL DIALS, CAR RADIO  
AND GLOVE COMPARTMENT**

**STAGE 38: REAR FLOOR AND  
FRONT SEAT BELTS**

**AGORA**  
MODELS

# Stage 31: Stabilizer Bar and Lower Suspension Arms

In stage 31, you will continue to build the suspension system.

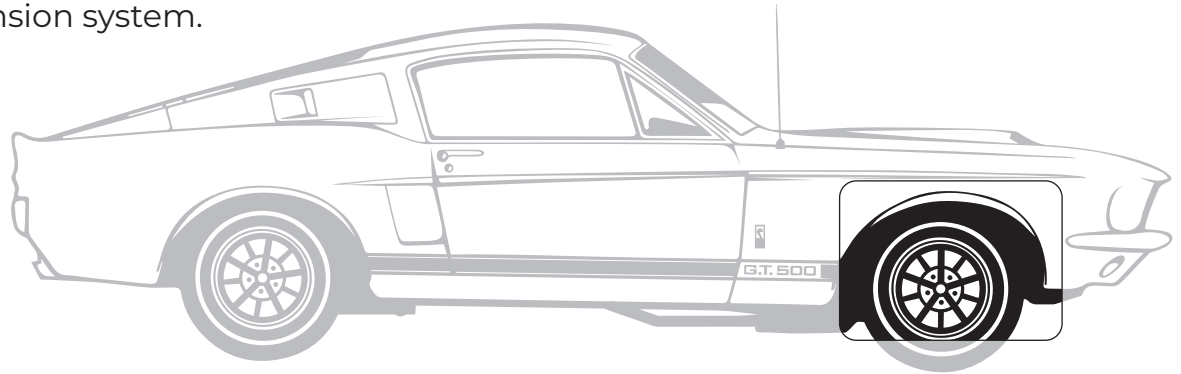

## STAGE 31 PARTS LIST

Name	Quantity
Stabilizer Bar and Lower Suspension Arms	1
Pins	2
Screws TYPE MP03	3 [inc. 1 spare]
Screws TYPE MD02	3 [inc. 1 spare]



# Stage 31: Stabilizer Bar and Lower Suspension Arms

## STEP 1

### ATTACH THE STABILIZER BAR AND LOWER SUSPENSION ARMS TO THE CHASSIS ASSEMBLY.

Take the Chassis Assembly and place it upside down on your worktable. Place the Stabilizer Bar in front of the frame as shown. Check you have it the right way up – the flat surface of the Stabilizer Bar faces down. This Bar is equipped with a Lower Suspension Arm for each front wheel. Now position the Lower Suspension Arm in the Arm Mounts fitted in Stage 30. Align the holes in the Arms and the Mounts. Insert one of the pins into the hole as shown in picture 3. Ensure that the ridged end of the pin protrudes from the hole. Squeeze the pin into the hole using a pair of pliers as shown in picture 4, checking to see that the pin reaches the other side of the Mount. Take extra care not to damage the paintwork.

Repeat on the Lower Suspension Arm on the opposite side.

Insert the Strut Rods into the corresponding holes in the chassis. Holding the Strut Rods in one hand, turn the Chassis Assembly over and fix into place using 2 x TYPE MP03 screws. Do not overtighten. The Strut Rods will be loose in the chassis to allow the front suspension to move.



#### ADVICE FROM THE EXPERTS

Cover your pliers in masking tape to help prevent damage to your paintwork.

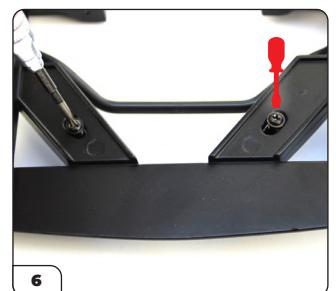
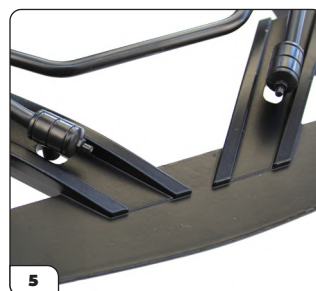
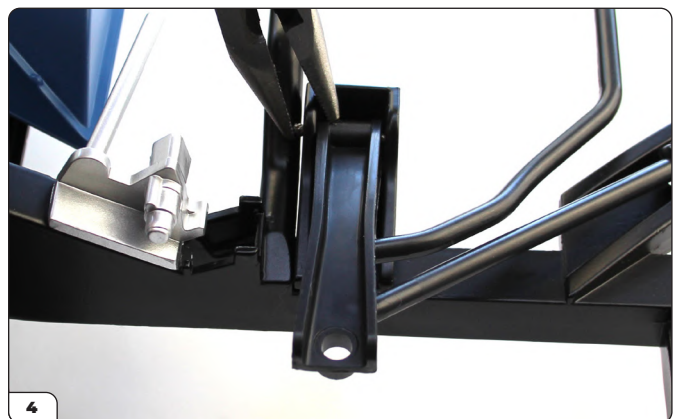
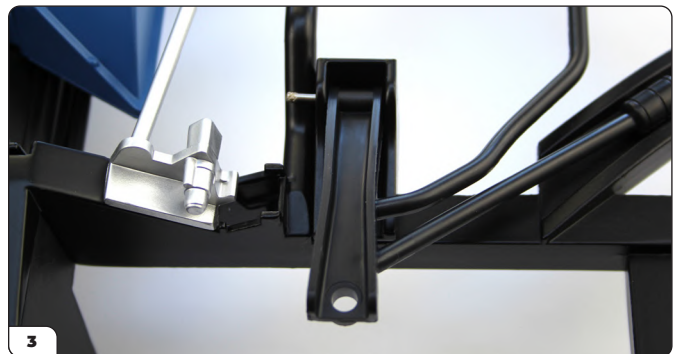
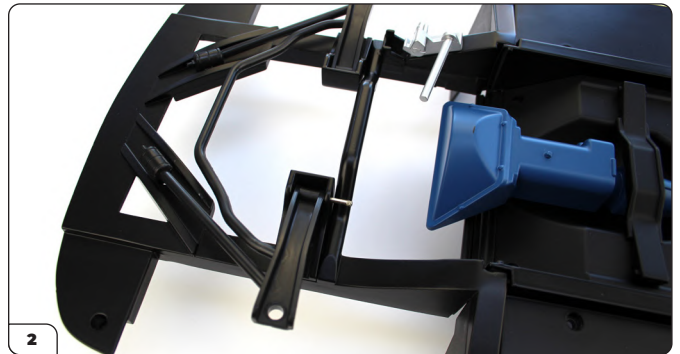
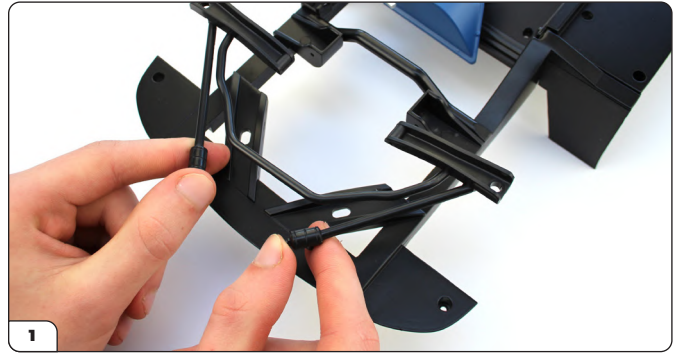

# Stage 31: Stabilizer Bar and Lower Suspension Arms

## STEP 2

### FIT THE TIE-ROD ASSEMBLY TO THE CHASSIS

Turn the Chassis Assembly over again and position the Tie-Rod Assembly completed in Stage 30, onto the chassis as shown. Note that the Pitman Arm must be fitted on the Steering Gear. Also note the Left Tie Rod must be fitted under the Steering Gear mounted on the chassis beam (indicated in picture 2). Keep screws MD02 safely as they will be used later.

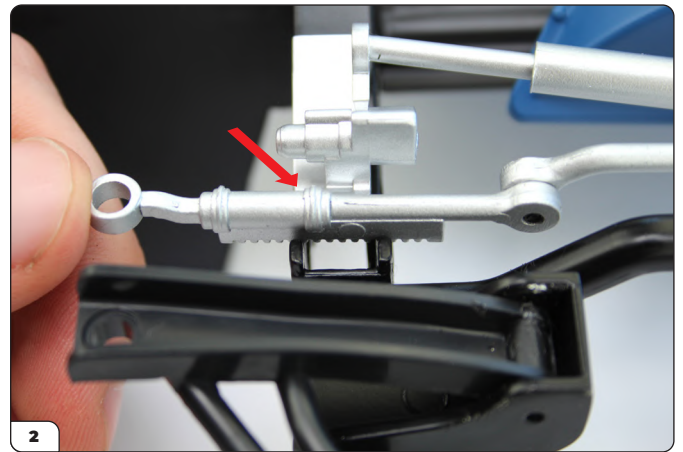
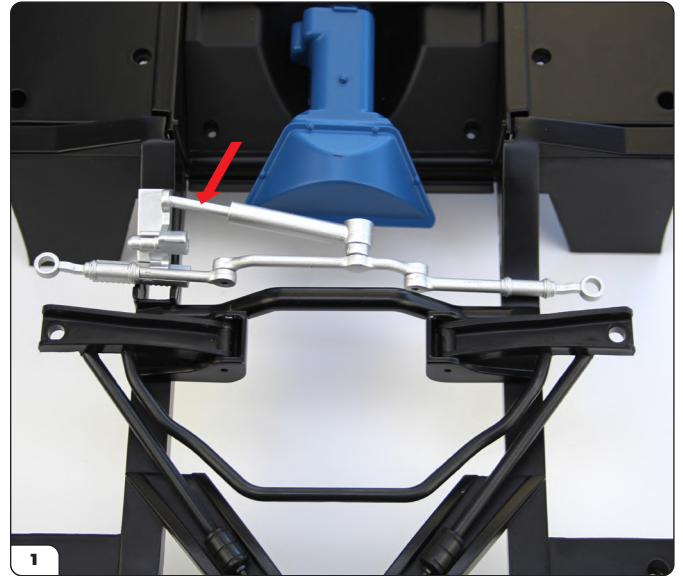



# Stage 31: Stabilizer Bar and Lower Suspension Arms

**Stage 31 complete!**



# Stage 32: Attaching the Upper Suspension Arms

Construct the Upper Suspension Arms and attach them to the chassis.

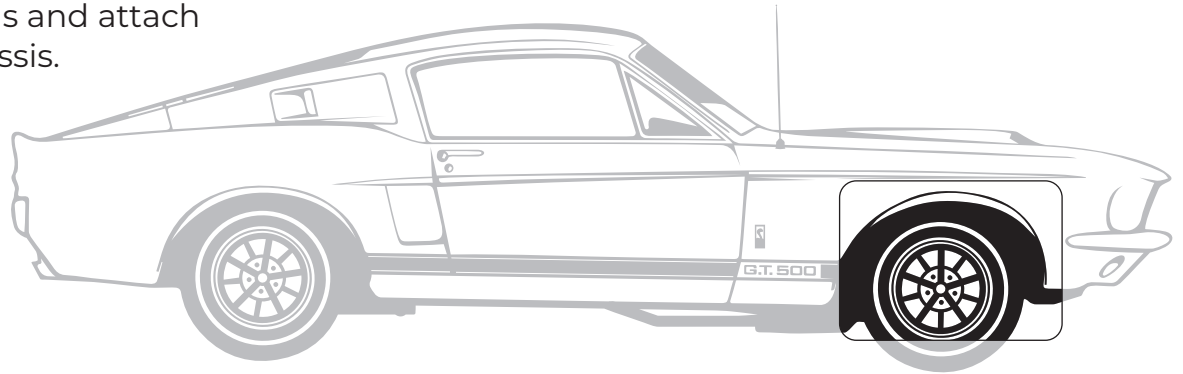

## STAGE 32 PARTS LIST

Name	Quantity
Upper Suspension Arms	2
Suspension Arm Supports	2
Pins	2
Screws TYPE MD06	5 [inc. 1 spare]
Screws TYPE MD02	3 [inc. 1 spare]

Upper Suspension Arms



Pins



Suspension Arm Supports



Screws



# Stage 32: Attaching the Upper Suspension Arms

## STEP 1

### CONSTRUCT THE UPPER SUSPENSION ARMS

Take one of the Upper Suspension Arms and one of the Suspension Arm Supports. Ensure you have the parts the correct way up by checking the picture. Push the two parts together so that the holes align. Push a Pin through the holes, ensuring that you leave the ridged end protruding. Push the Pin through so that it is flush with the Upper Suspension Arms using a pair of pliers. Repeat this process using the remaining parts.



# Stage 32: Attaching the Upper Suspension Arms

## STEP 2

### FIX THE UPPER SUSPENSION ARMS TO THE CHASSIS

Take the Chassis Assembly and position the Upper Suspension Arms created in STEP 1 on the side of the chassis as shown. Check the Suspension Arm can move freely to 90 degree position. Fix in place using 2 x TYPE MD06 screws. Repeat this process on the opposite side of the chassis.



## Stage 32 complete!

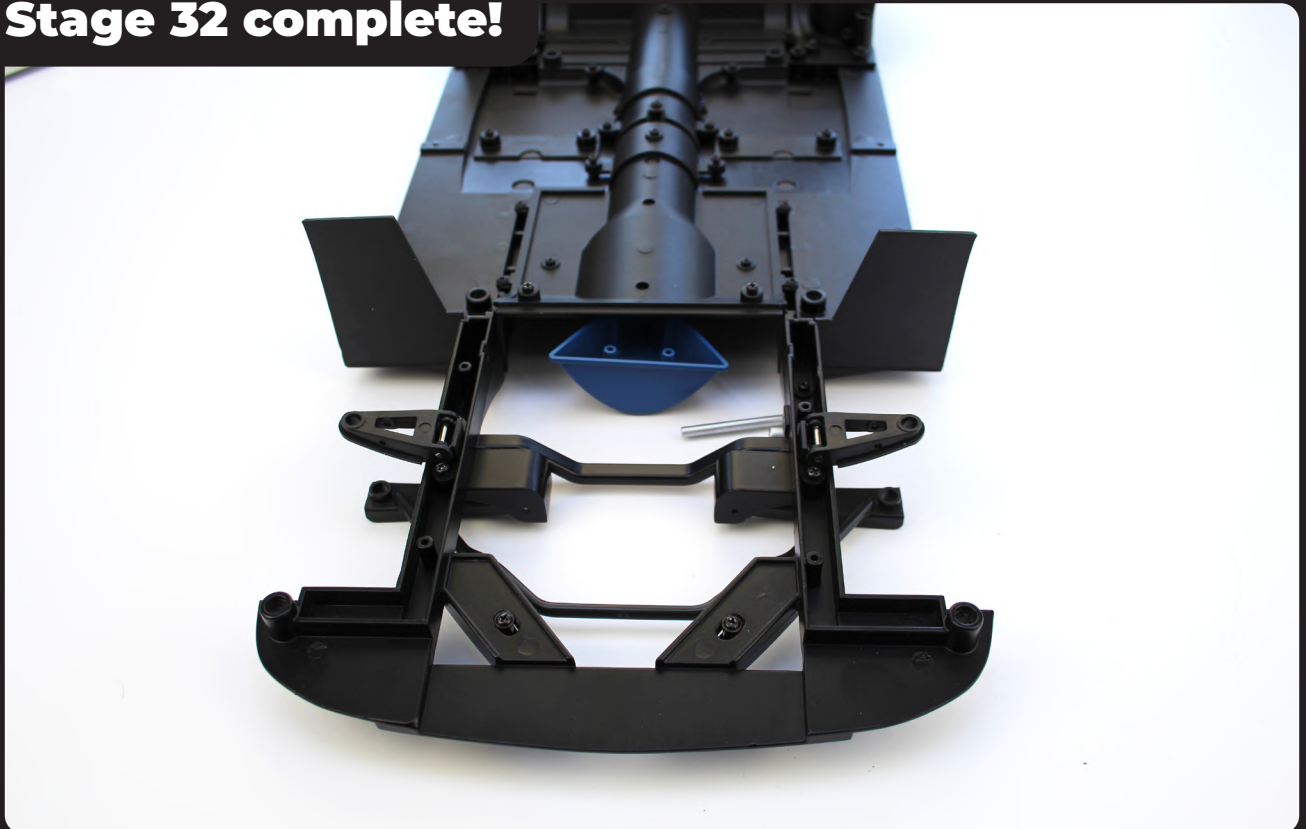



## Stage 33: Attaching the Gear Lever to the Front Interior Floor

You are now going to start building the front interior of the Shelby Super Snake.

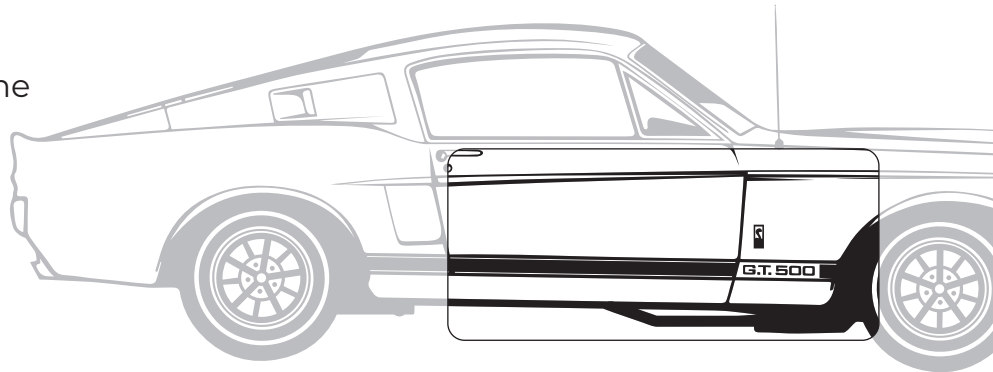

### STAGE 33 PARTS LIST

Name	Quantity
Front Interior Floor	1
Gear Lever	1
Screws TYPE MP01	2 [inc. 1 spare]



## Stage 33: Attaching the Gear Lever to the Front Interior Floor

### STEP 1

#### FIXING THE GEAR LEVER

Position the interior floor on your workbench as shown. Take the Gear Lever and align the lug on the base with the hole in the Floor. Ensure the Gear Lever knob is facing the direction shown. Holding the Gear Lever in position with one hand, turn the Floor over; fix in place with a MP01 screw.



### Stage 33 complete!

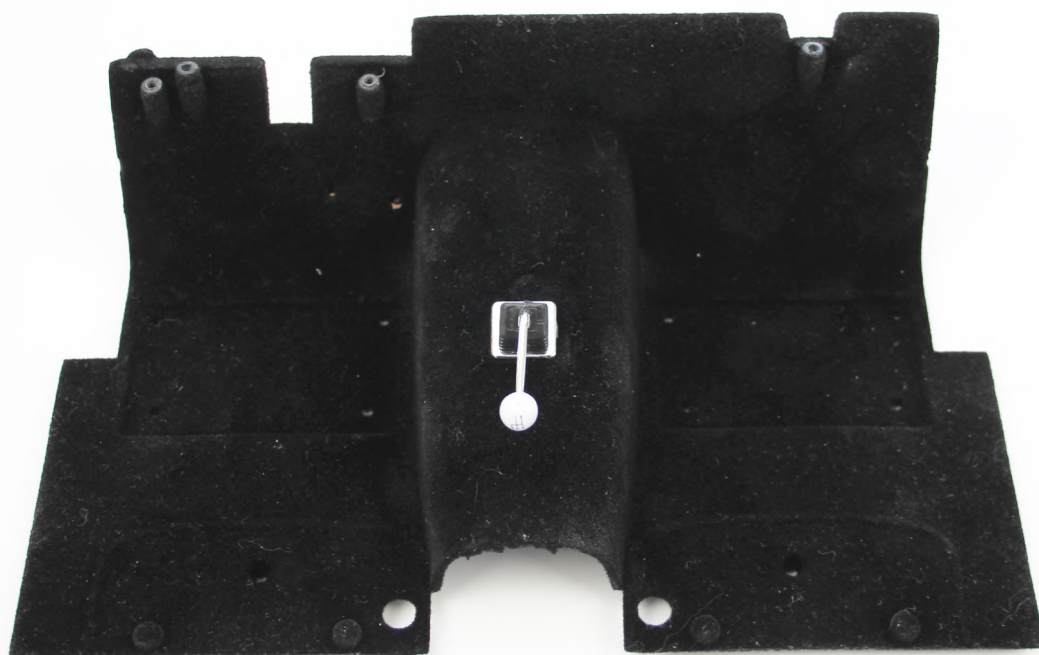

## Stage 34: Front Side Walls, Pedals and Switches

You will continue building the front interior, adding switches and pedals.

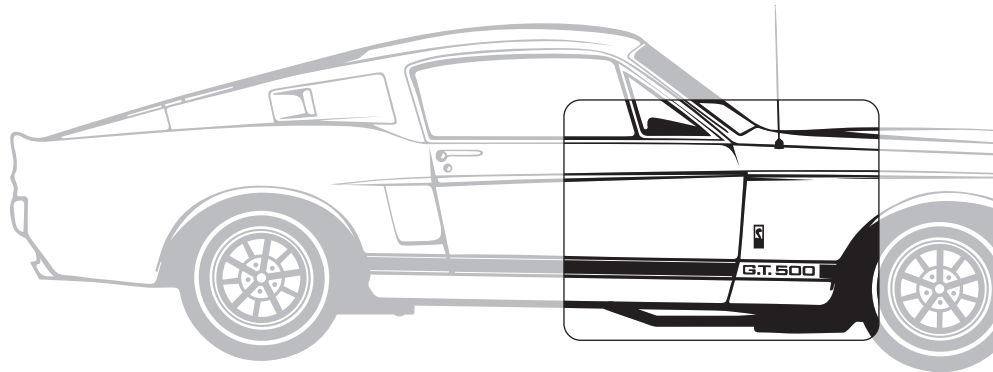

### STAGE 34 PARTS LIST

Name	Quantity
Front Floor Right Side Wall	1
Front Floor Left Side Wall	1
Switch Holder	1
Accelerator Pedal Switch	1
Brake Pedal Switch	1
Pedals	1
Screws TYPE MP01	8 [inc. 1 spare]
Screws TYPE MP03	3 [inc. 1 spare]



# Stage 34: Front Side Walls, Pedals and Switches

## STEP 1

### FIX THE SIDE WALLS TO THE FRONT INTERIOR FLOOR

Take the Front Interior Floor from stage 33 and align the Right Side Wall as shown. Snap the Side Wall tabs onto the studs of the Interior Floor starting with the stud shown by an arrow in picture 1. Fix in place using 2 x TYPE MP01 screws; followed by a MP03 screw as shown in picture 2. Position the Front Left Side Panel on the opposite side of the Floor and snap into place. Fix in place with 2 x MP01 screws and a MP03 screw as shown in picture 3.

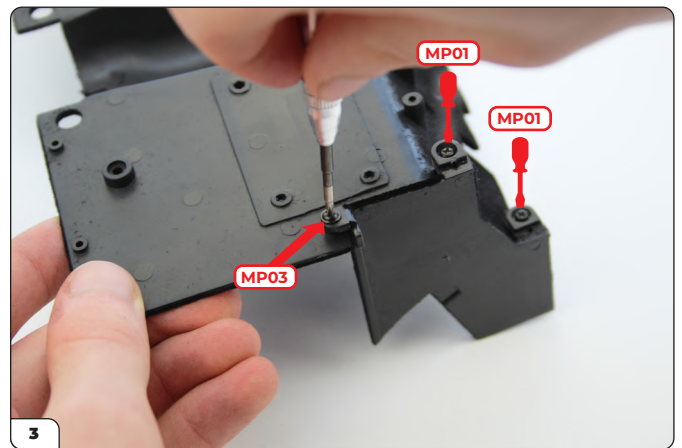
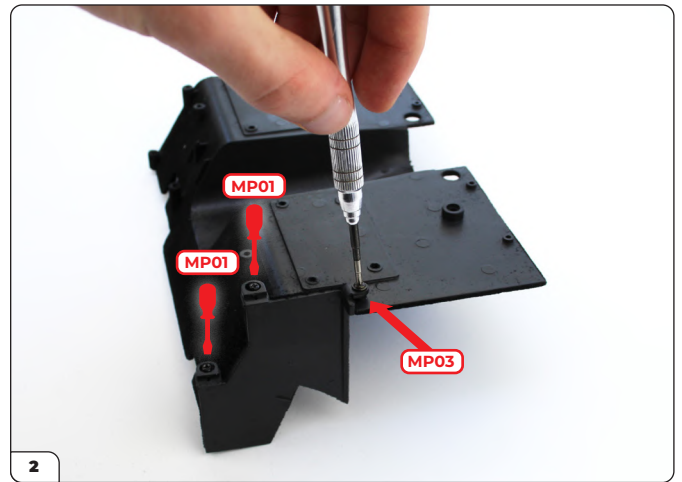
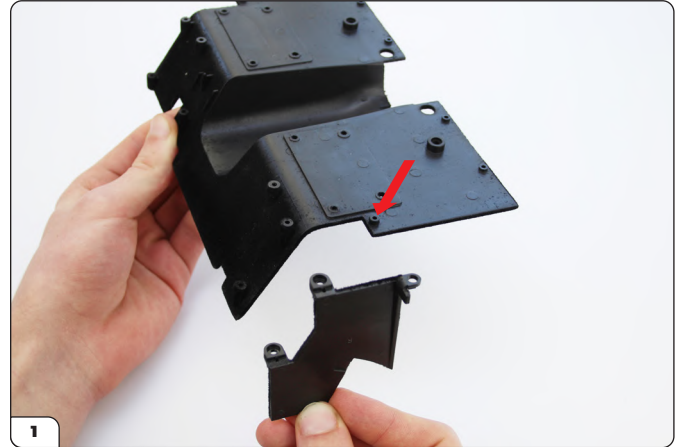



# Stage 34: Front Side Walls, Pedals and Switches

## STEP 2

### CONSTRUCT THE SWITCHES AND FIX TO THE FRONT INTERIOR FLOOR

Now take the Switch Support Box and position the Accelerator and Brake switches as shown. Note: You must ensure the buttons are facing upwards as shown, and that the 01 and 02 switches, indicated by the numbers on the white connectors at the end of each cable, are in the correct position. Holding the switches in one hand, attach the Support Box & Switch Assembly to the Front Floor. The Assembly is positioned by snapping the top of the Support Box over the hook shown in picture 3. Secure in place with an MP01 screw. Make sure the buttons are inserted into the holes.



#### ADVICE FROM THE EXPERTS

The switches may be a little loose in the support box. This is perfectly normal.

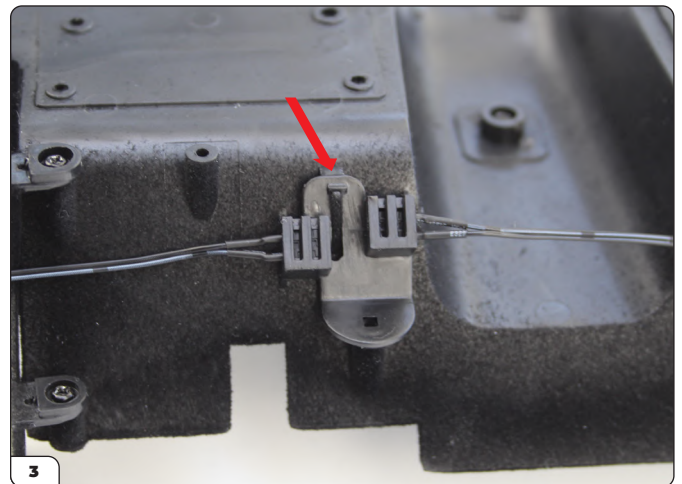

## Stage 34: Front Side Walls, Pedals and Switches

### STEP 3

#### ATTACH THE PEDALS

Turn the Floor the right way up and position the Pedals as shown. Note that the brake pedal and the accelerator pedal have tabs. These tabs will activate the switches, so take extreme care not to damage them. Check that the tabs are positioned on the switches and fix in position using 2 TYPE MP01 screws. Gently press the pedals. You will hear a 'click' if positioned correctly. If the switches are not clicking, try loosening the screws a little.

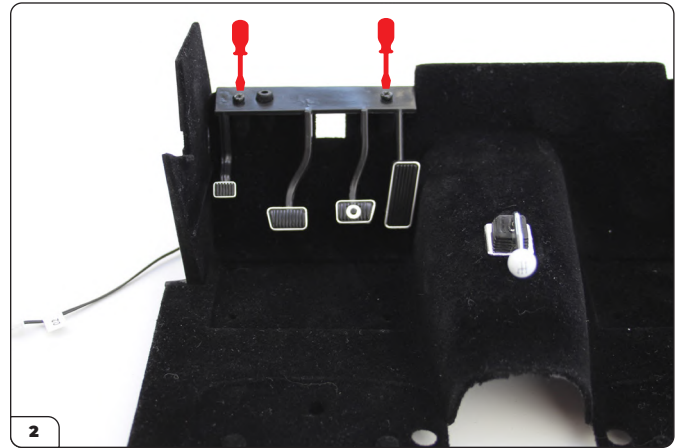
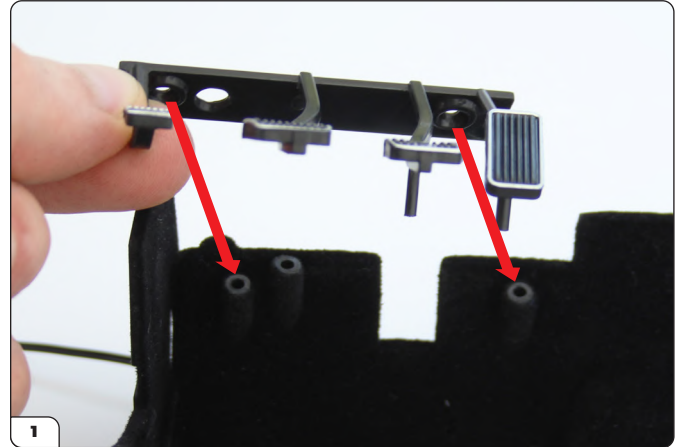

### Stage 34 complete!

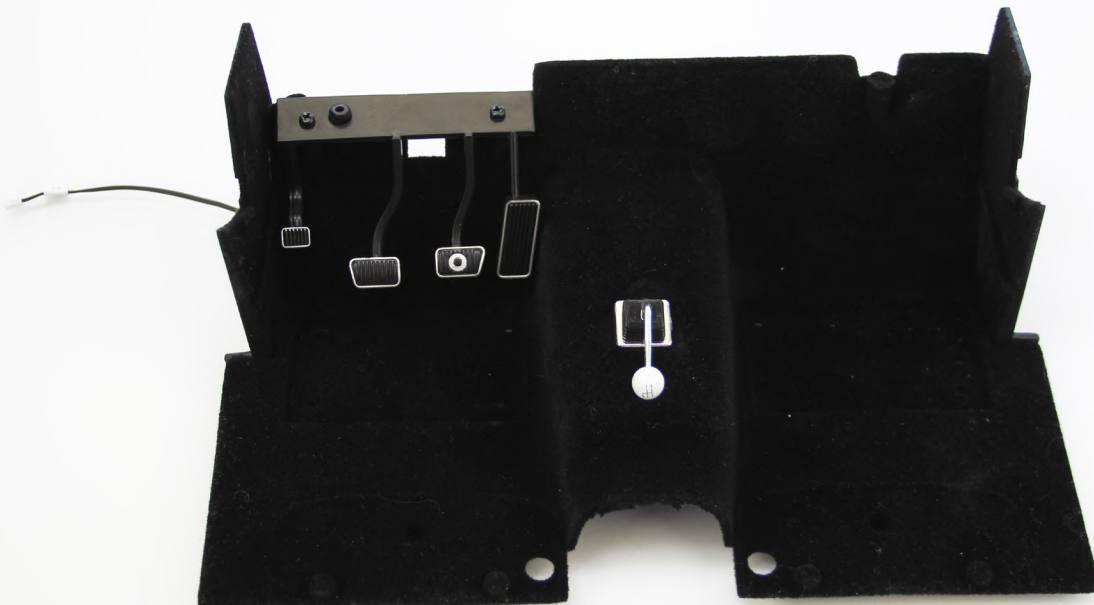

## Stage 35: Dashboard And Fuse Cover

You are now going to start building the dashboard.

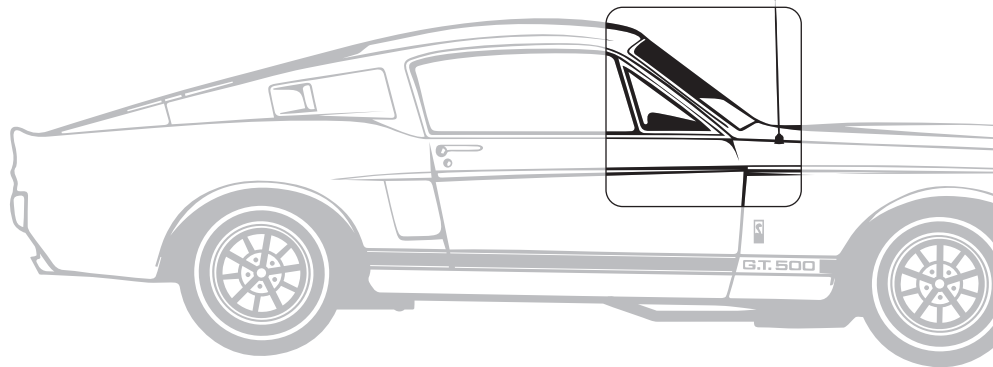

### STAGE 35 PARTS LIST

Name	Quantity
Dashboard	1
Fuse Cover	1
Screws TYPE MP03	2 [inc. 1 spare]



# Stage 35: Dashboard And Fuse Cover

## STEP 1

### ATTACH THE FUSE COVER TO THE DASHBOARD

Align the Dashboard and Fuse Cover as shown in the picture. Press the Fuse Cover into place checking that the notch on the cover is at the bottom. Turn the dashboard over and fix the cover in place with a TYPE MP03 screw.

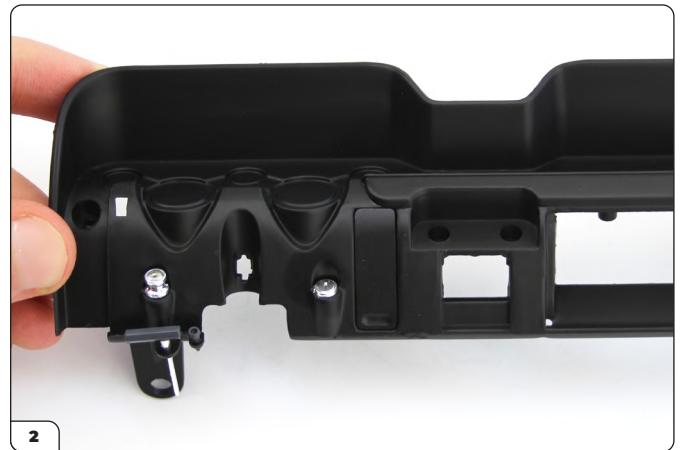
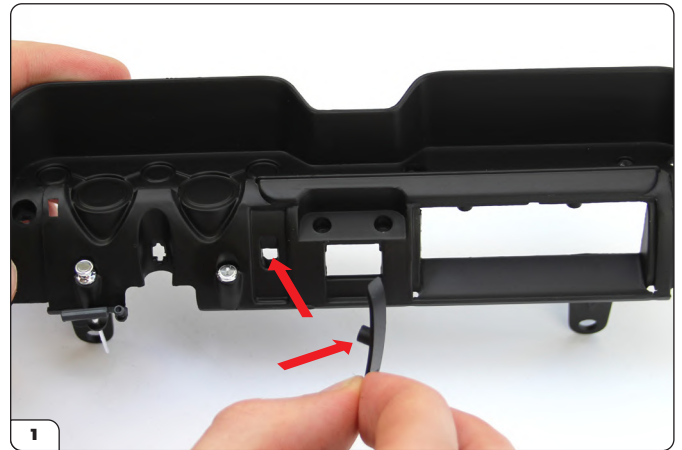



## Stage 35: Dashboard And Fuse Cover

**Stage 35 complete!**

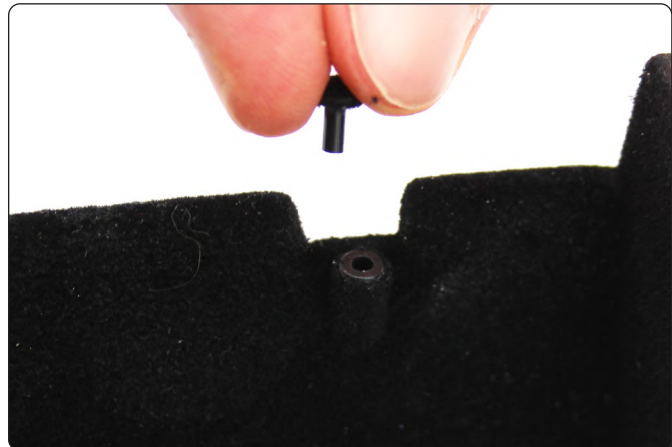

This picture shows the Dashboard resting in place on the Front Floor. There may be a carpeted peg or screw in the front floor (inset). This must be removed before positioning the Dashboard.

# Stage 36: Dashboard Trim, Dials and Shelby Badge

In this stage you will continue to construct the dashboard.

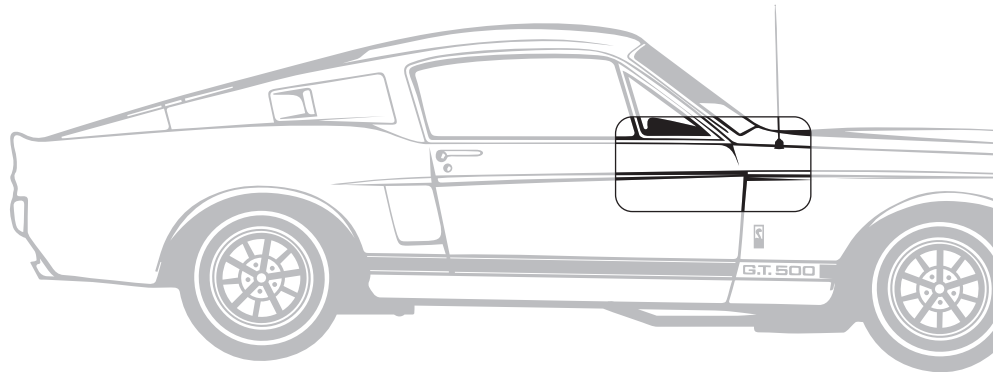

## STAGE 36 PARTS LIST

Name	Quantity
Adhesive Dials	1
Glass Dial covers	1
Dashboard Trim	1
Dashboard Strip	1
Shelby Badge Support	1
Screws TYPE MP01	4 [inc. 1 spare]
Screws TYPE MP05	3 [inc. 1 spare]



# Stage 36: Dashboard Trim, Dials and Shelby Badge

## STEP 1

### ATTACH THE DIAL ADHESIVES TO THE DASHBOARD

In picture 1, the adhesive dials have been identified by letters to allow them to be placed in the correct order. Remove letter A from the sheet using the point of a scalpel or similar tool and place on the dashboard from stage 35 as indicated by the arrow in picture. Ensure the dial is centered and press to fix in place. Repeat this process for dials B, C, D and E, placing them as shown in picture 3.

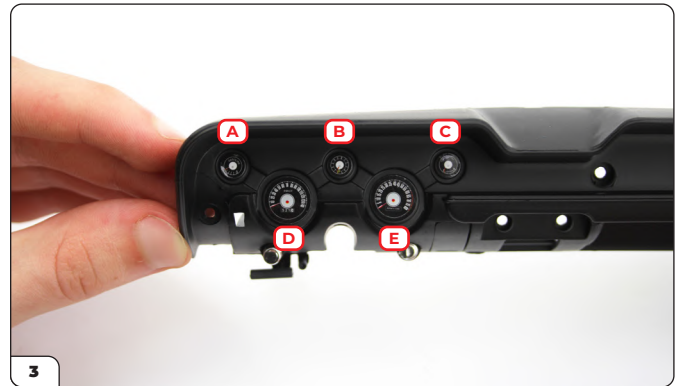
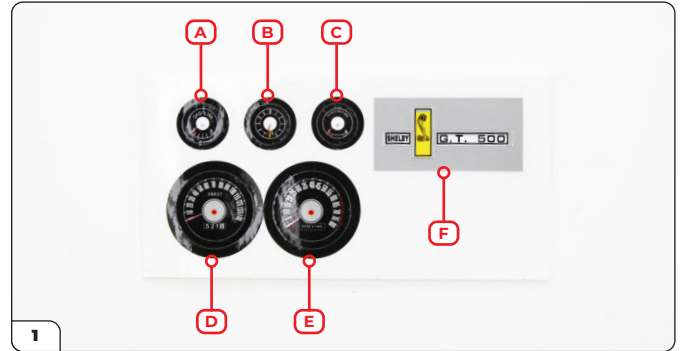

# Stage 36: Dashboard Trim, Dials and Shelby Badge

## STEP 2

### POSITION THE DIAL GLASS ON THE DASHBOARD TRIM AND FIX BOTH THE DASHBOARD TRIM AND DASHBOARD STRIP TO THE DASHBOARD ASSEMBLY.

Take the Dial Glass and note that the larger dials are thicker. Align with the Dashboard Trim and press to fit them together so that the surface of the Glass is flush. The thicker glass projects slightly into the holes. Position the Dial and Dashboard Trim Assembly onto the Dashboard. Next, align the holes on the Dashboard Strip with the holes on the Dashboard Trim and press the two pieces gently together. Turn the assembly over and fix together using 3 x TYPE MP01 screws in the order indicated by the numbers in picture (5).



#### ADVICE FROM THE EXPERTS

Polish any finger marks off the Dial Glass before fixing the Dash Trim in place.

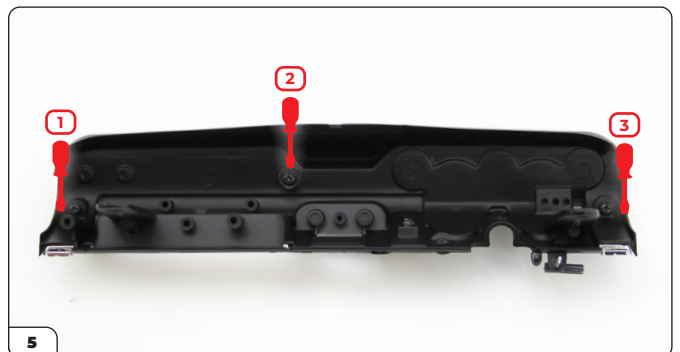
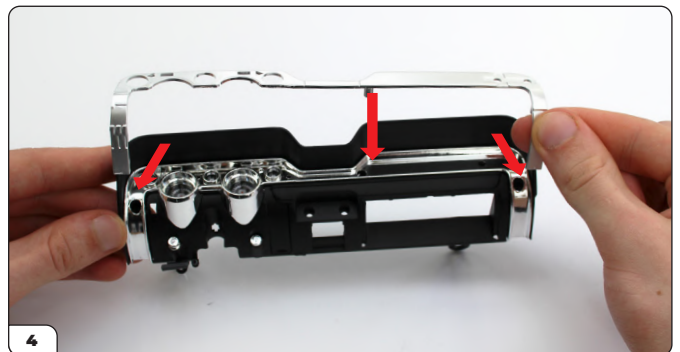
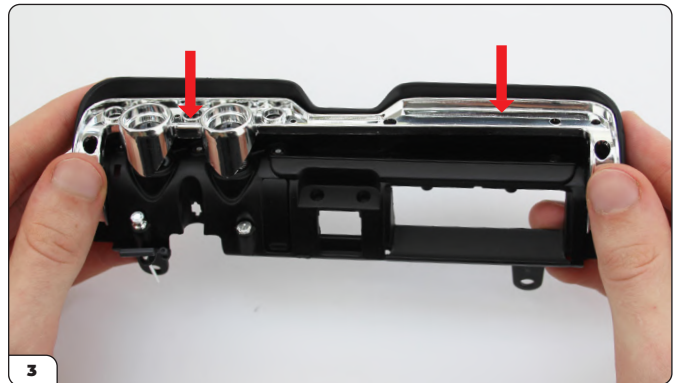
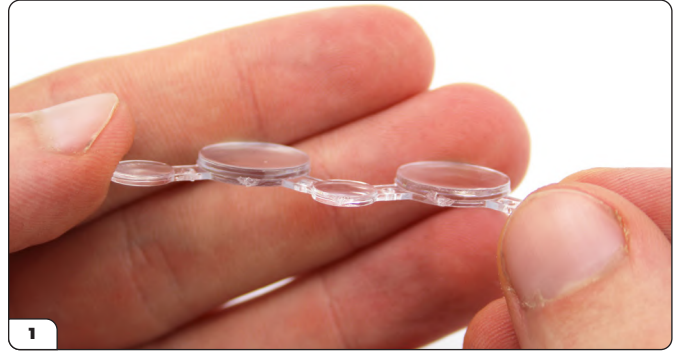



# Stage 36: Dashboard Trim, Dials and Shelby Badge

## STEP 3

### FIX THE SHELBY STICKER SUPPORT TO THE DASHBOARD STRIP

Take the Shelby Badge Support and place sticker F into place on the Support. Align the holes on the Support with the holes on the Dashboard Strip and push together to fit the part temporarily. Holding the badge in position, turn the assembly over and fix the badge to the Dashboard using 2 x TYPE MP05 screws.

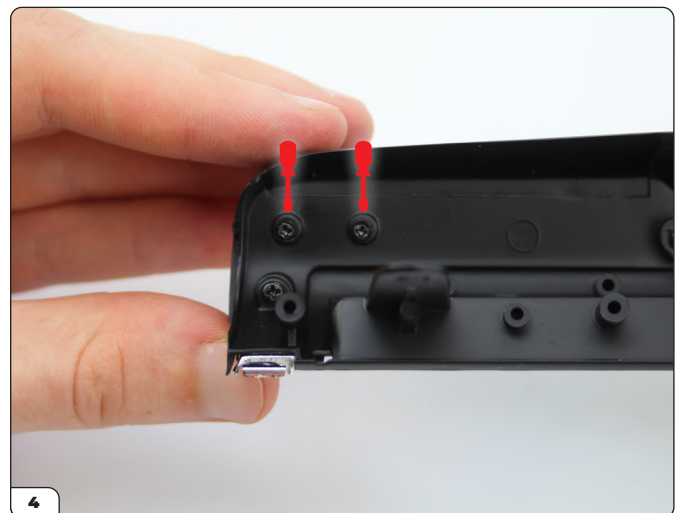
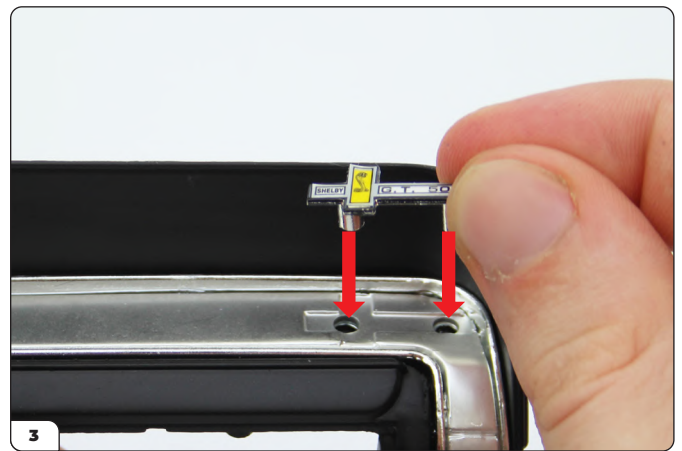
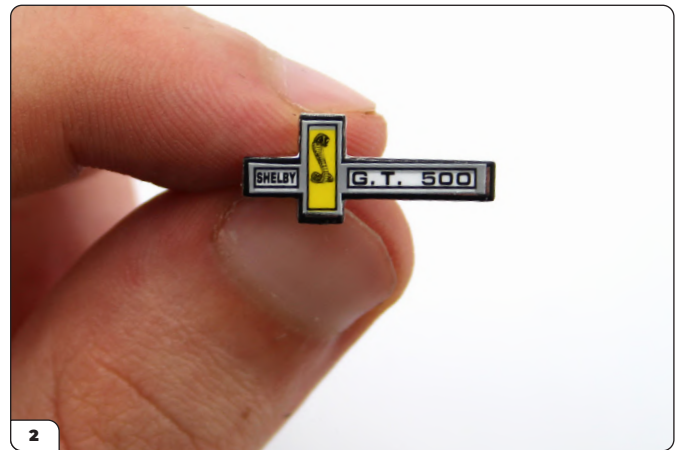
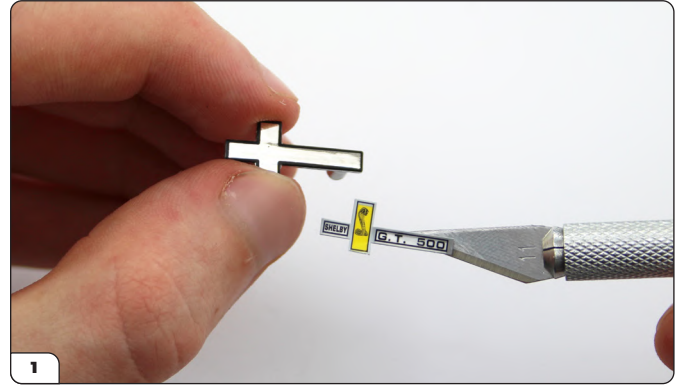

# Stage 36: Dashboard Trim, Dials and Shelby Badge

**Stage 36 complete!**



# Stage 37: Central Dials, Car Radio and Glove Compartment

You will continue adding more details to the dashboard.

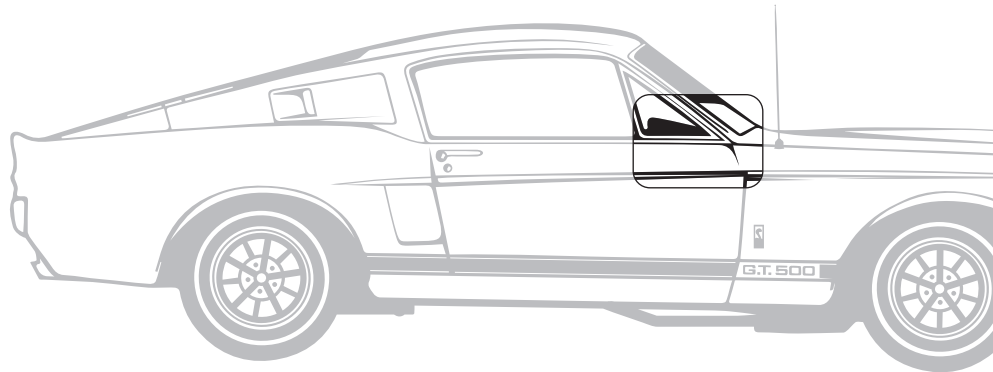

## STAGE 37 PARTS LIST

Name	Quantity
Car Radio	1
Adhesive Dials	1
Central Dial Support	1
Dial Glass	1
Dial Frames	1
Glove Box Bottom	1
Glove Box Cover	1
Screws TYPE MP01	6 [inc. 1 spare]
Screws TYPE MP05	3 [inc. 1 spare]
Screws TYPE MP03	3 [inc. 1 spare]

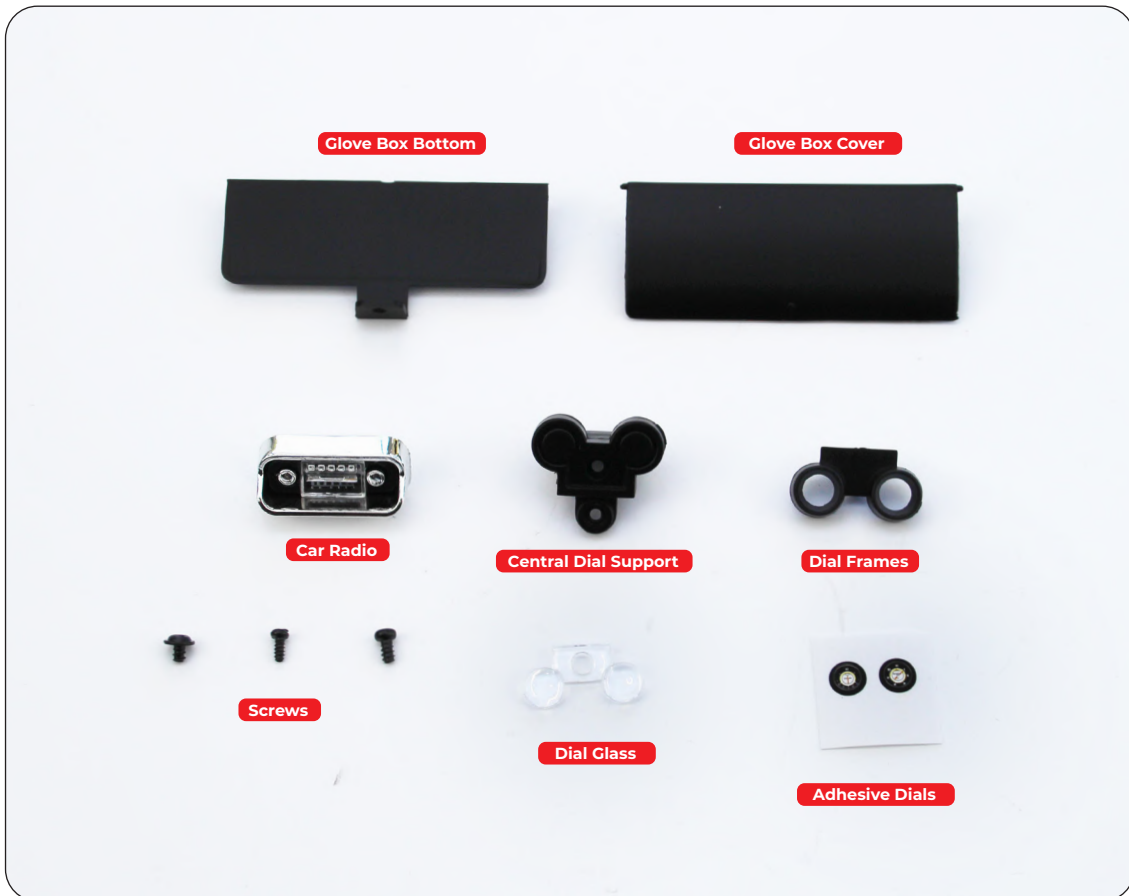

# Stage 37: Central Dials, Car Radio and Glove Compartment

## STEP 1

### ATTACH THE CAR RADIO

Align the lugs on the Car Radio with the holes on the Dashboard and press into position. Holding the radio in place turn the assembly over and fix into position from the rear using 2 x TYPE MP01 screws.

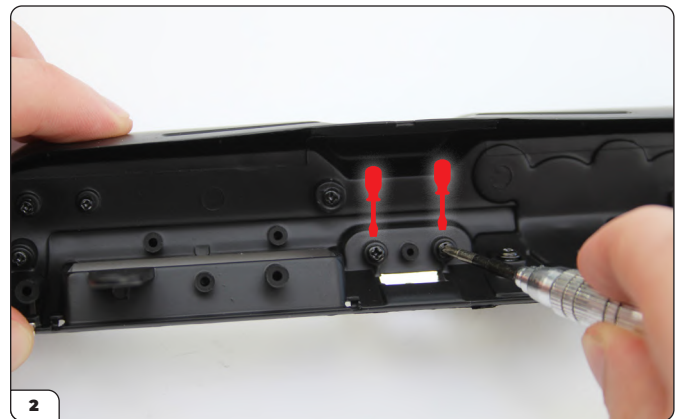



# Stage 37: Central Dials, Car Radio and Glove Compartment

## STEP 2

### CONSTRUCT THE CENTRAL DIALS

Identify the stickers using the letters as indicated in picture 1. Place the stickers in alphabetical order onto the Central Dial Support. Use the tip of a scalpel or similar tool to help remove and position the stickers. Position the Dial Glass into place on the Central Dial Support. Position the Dial Frame onto the Dial Support; this will keep the Dial glass in place. Turn the assembly over and fix it with a TYPE MP05 screw.



### ADVICE FROM THE EXPERTS

If you find the MP05 screw strips the thread, you can use a spare MP01 screw.

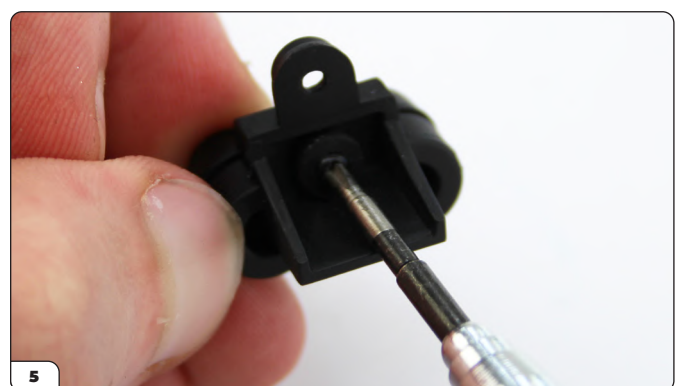
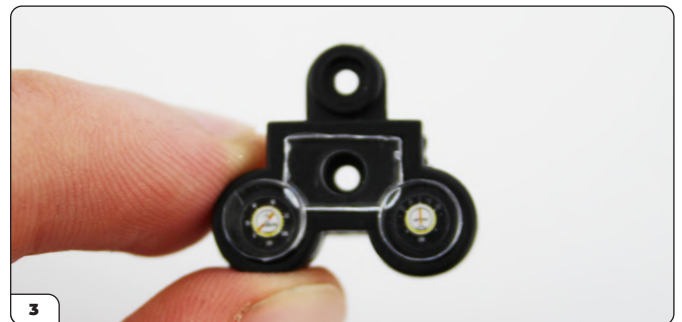

# Stage 37: Central Dials, Car Radio and Glove Compartment

## STEP 3

### ATTACH THE CENTRAL DIALS TO THE DASHBOARD

Place the part assembled in step 2 through the central groove on the Dashboard, ensuring that the projecting hole and the lug on the dashboard fit together correctly. Fix in place using a TYPE MP05 screw. Picture 3 shows the Central Dials fitted below the Car Radio.



## STEP 4

### ATTACH THE GLOVE COMPARTMENT TO THE DASHBOARD

Now position the Glove Box Bottom on the back of the Dashboard, matching the holes as shown in picture 1. Secure with 3 x TYPE MP01 screws in the order shown. Position the Glove Box Cover on the Dashboard and press the parts together. Check that the glove box now opens and closes correctly.

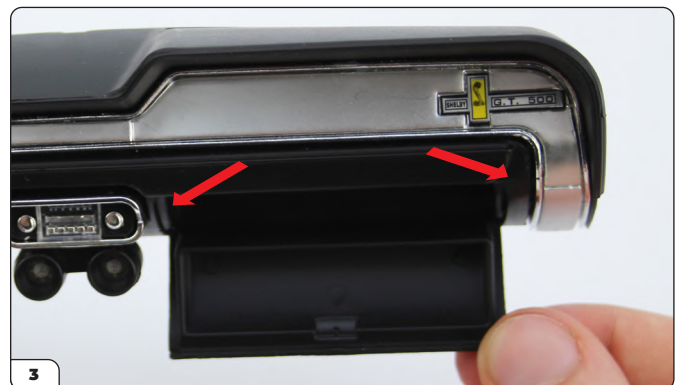
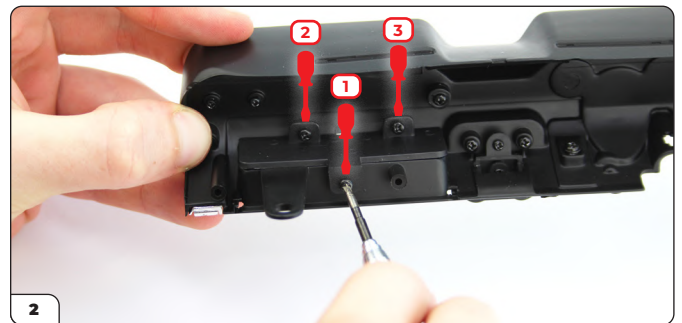
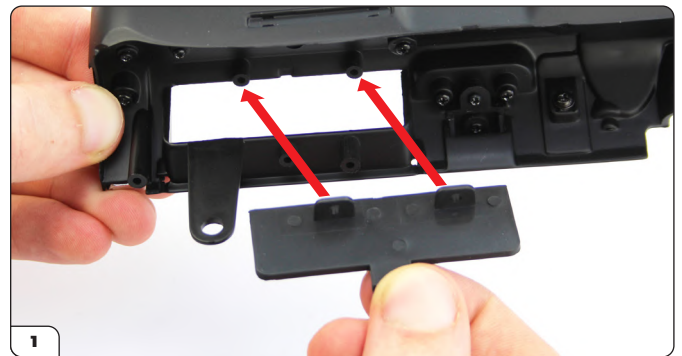

# Stage 37: Central Dials, Car Radio and Glove Compartment

## STEP 5

### ATTACH THE DASHBOARD TO THE FRONT INTERIOR FLOOR

Fit the Dashboard to the Interior Floor by fitting the Dashboard projections over the screw holes as shown. Take care to align and fit the grooves on the side walls with the projections on the sides of the Dashboard. Secure the assembly with 2 x TYPE MP03 screws.



## Stage 37 complete!



## Stage 38: Rear Floor and Front Seat Belts

You are now going to attach the front floor to the rear floor and add the front seat belts.

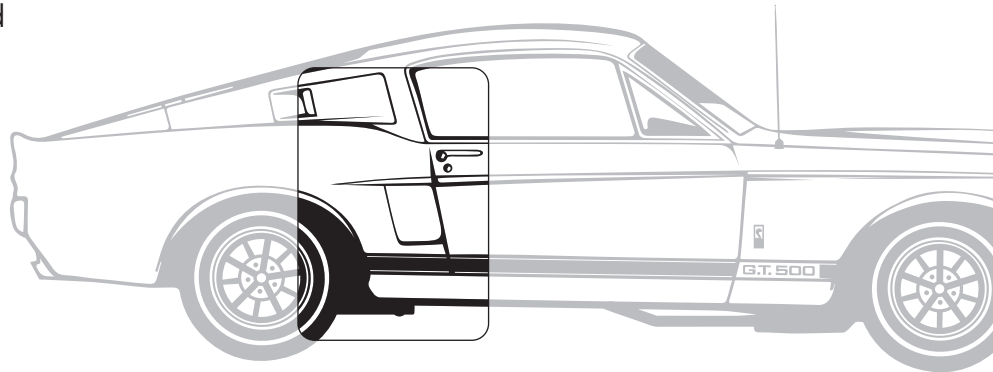

### STAGE 38 PARTS LIST

Name	Quantity
Rear Floor	1
Passenger's Seat Belt Anchor	1
Driver's Seat Belt Anchor	1
Front Seat Belts	2
Screws TYPE MP01	9 [inc. 1 spare]

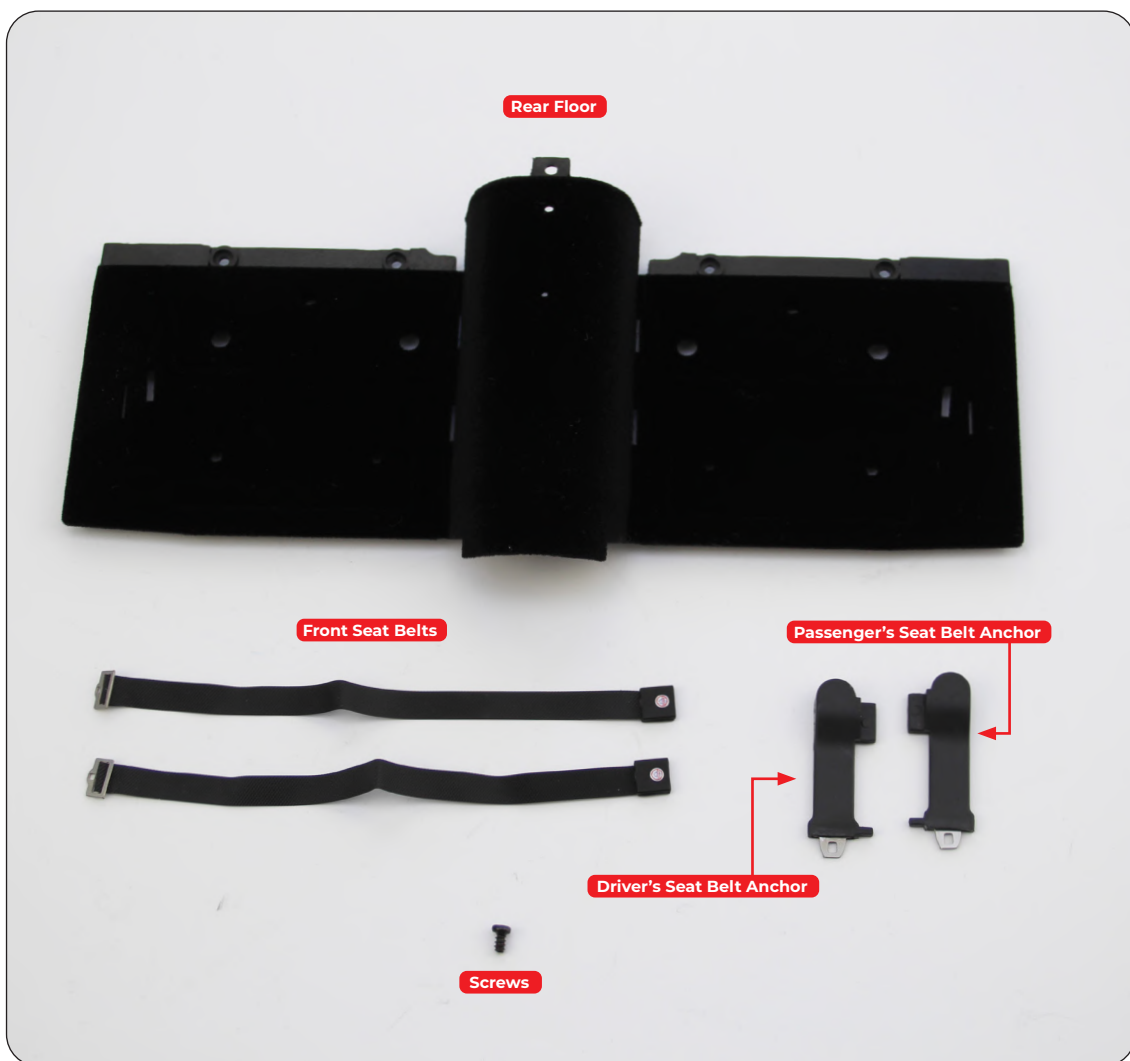



# Stage 38: Rear Floor and Front Seat Belts

## STEP 1

### FIT THE FRONT SEAT BELT ANCHORS

Align the lugs on the Passenger's Seat Belt Anchor with the holes on the right side of the Rear Floor as shown. Push the two pieces together so they snap into position. Repeat this operation for attaching the Driver's Seat Belt Anchor on the opposite side.

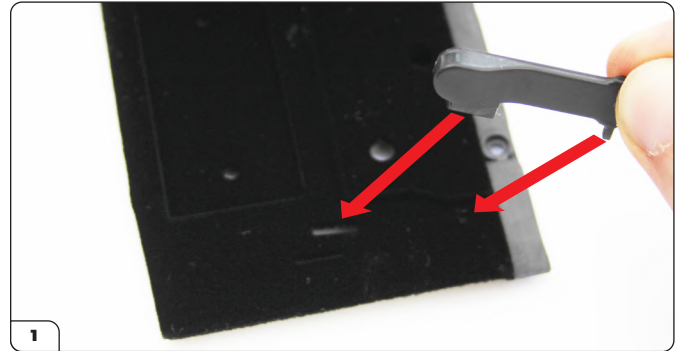

## STEP 2

### ATTACH THE FRONT FLOOR ASSEMBLY TO THE REAR FLOOR

Take the Front Floor Assembly and align it with the Rear Floor. Snap the two pieces together as shown, ensuring that the holes and lugs are correctly fitted together as indicated by the five arrows. Gentle pressure might be required for the central lug. Use 4 x TYPE MP01 screws to fix the pieces together in the order indicated by the numbers. Keep the remaining TYPE MP01 screws safely for use in a later stage.

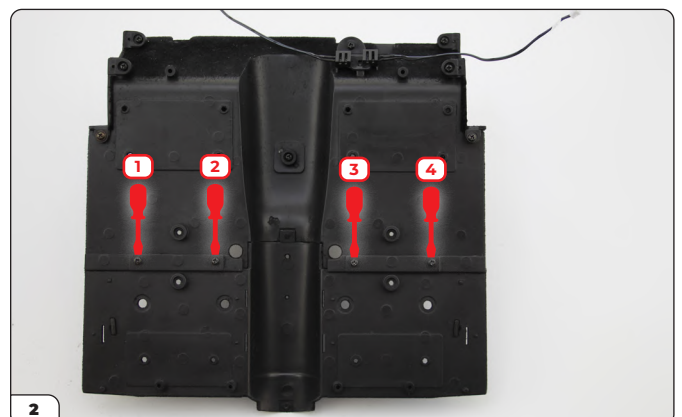
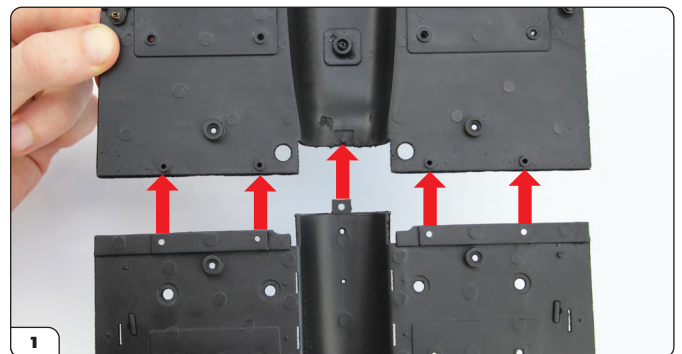

# Stage 38: Rear Floor and Front Seat Belts

## STEP 3

### FIT THE FRONT SEAT BELTS

Take one of the Front Seat Belts and align with the groove in the Floor. The Cobra badge should face upwards at the opposite end. Push the end of the Seat Belt through the slot and snap onto the projecting post on the underside of the Floor. Press to fix in place. Repeat this operation for the remaining Seat Belt on the opposite side of the Floor.



### ADVICE FROM THE EXPERTS

Using tweezers may make it easier to push the end of the Seat Belt through the slot. A small piece of masking tape will ensure that the ends don't pop off the post before the floor is fixed in place, but don't cover any other slots or holes.

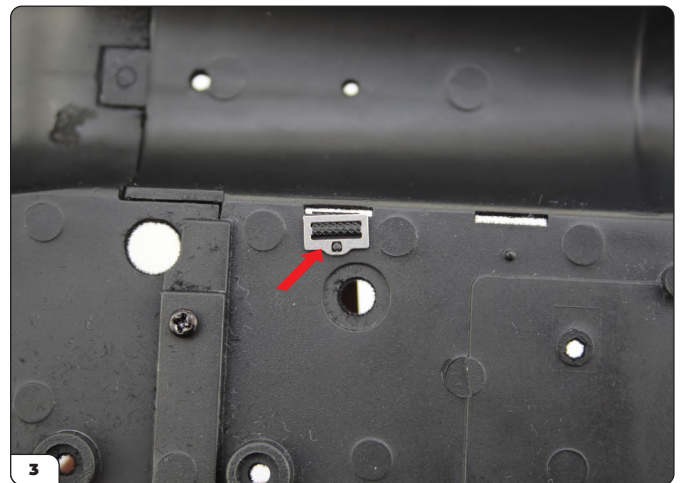
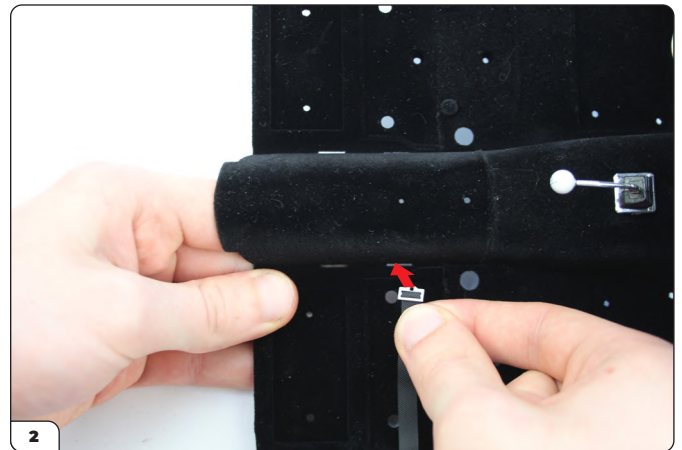

# Stage 38: Rear Floor and Front Seat Belts

**Stage 38 complete!**

